

Heating, air-conditioning, cooling

Glanded monobloc pumps (single pumps)

WILO

Series description Wilo-CronoBloc-BL

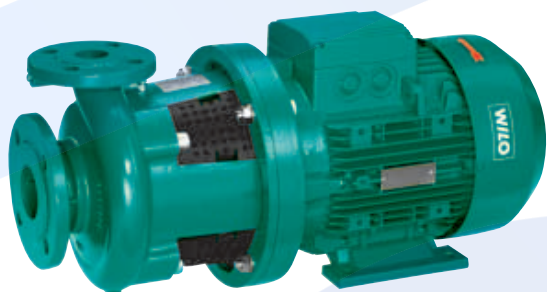

Materials

- Pump housing and lantern: Standard: EN-GJL-250; optional: Spheroidal cast iron EN-GJS-400-18-LT
- Impeller: Standard: EN-GJL-200; Special version: Red brass G-CuSn10
- Shaft: 1.4122
- Mechanical seal: AQEGG; other mechanical seals on request

Description/design

Single-stage low-pressure centrifugal pump in block design, with axial suction port and radially arranged pressure port with

- Mechanical seal
- Flange connection with pressure measuring connection R $\frac{1}{8}$
- Lantern
- Coupling
- IEC standard motor

Design

Glanded pump in block design with flange connection

Application

For pumping cold and hot water (in accordance with VDI 2035) without abrasive substances in heating, cold water and cooling water systems

Scope of delivery

- Pump
- Installation and operating instructions

Type key

Example	BL 40/160-4/2
BL	Monobloc pump
40	Nominal diameter DN of the pipe connection (pressure port)
160	Nominal impeller diameter
4	Nominal motor power P_2 in kW
2	Pole pair number

Technical data

- Permissible temperature range -20°C to $+140^{\circ}\text{C}$
- Mains connection 3~400 V, 50 Hz
- Protection class IP 55
- Nominal diameter DN 32 to DN 125
- Max. operating pressure 16 bar (optionally 25 bar on request)

Special features/product benefits

- High-efficiency motors as standard; from 0.75 kW nominal motor power: motors with IE2 technology
- Reduced life cycle costs due to optimised efficiency
- High corrosion protection due to cathoretic coating of the cast iron components
- Standard condensate drainage holes in the motor housings
- Application benefits in air-conditioning and cooling systems due to direct condensate drainage by means of optimised lantern design
- Bidirectional mechanical seal with forced flushing
- High worldwide obtainability of standard motors (according to Wilo specifications) and mechanical seals
- Meets user requirements due to performance and main dimensions in accordance with EN 733 (DIN for norm pumps)

Heating, air-conditioning, cooling

Glanded monobloc pumps (single pumps)

Series description Wilo-CronoBloc-BL

Wilo-CronoBloc (4-pole)

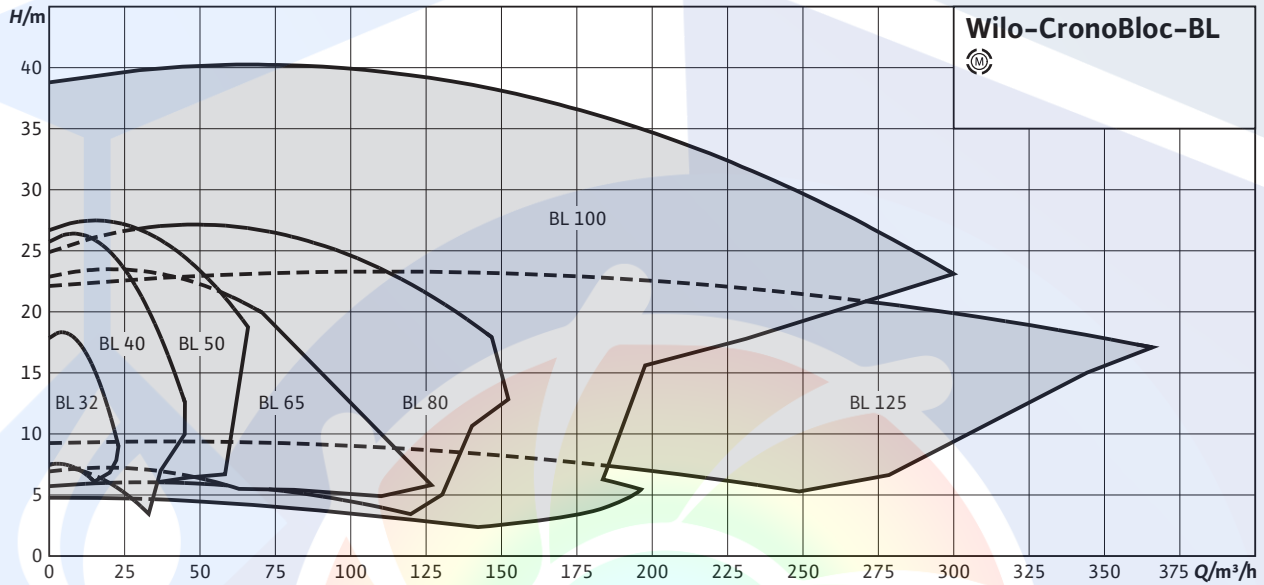

Wilo-CronoBloc (2-pole)

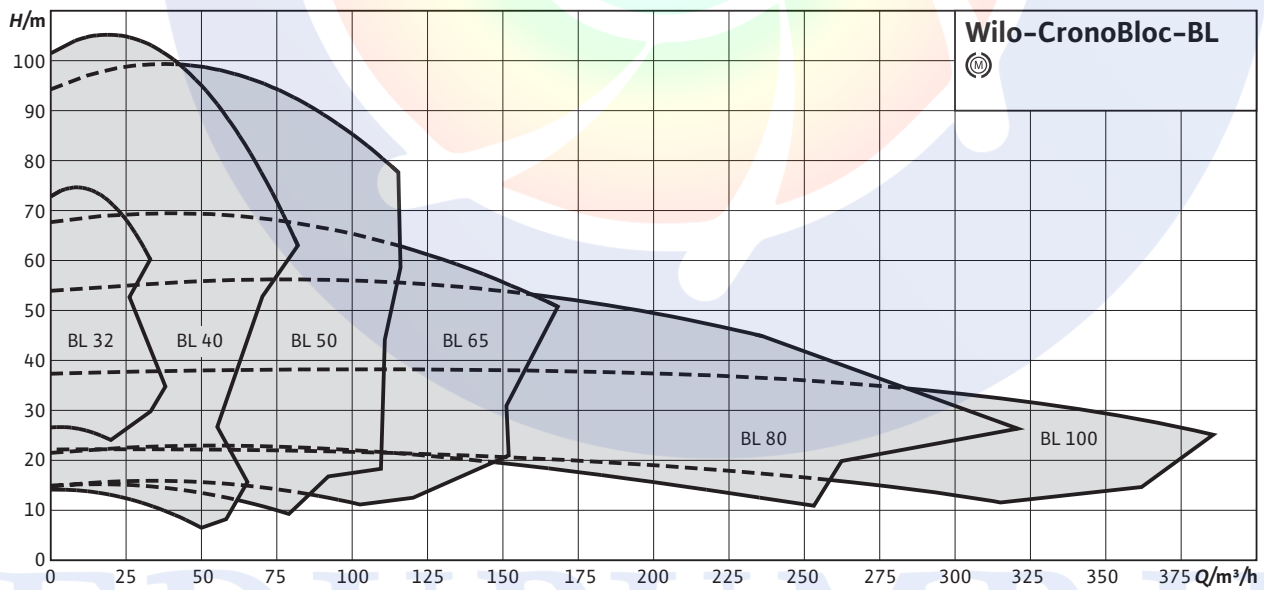

Pump curves Wilo-CronoBloc-BL

Wilo-CronoBloc-BL 80/200-3/4 - 80/220-5,5/4

4-pole, 50 Hz

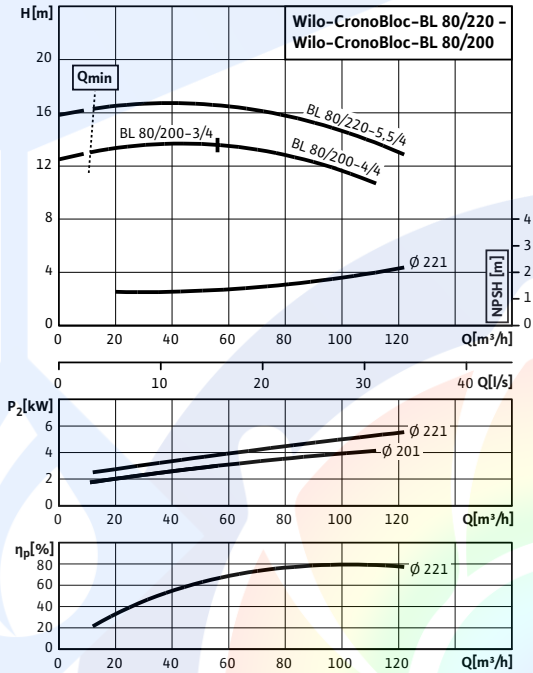

Wilo-CronoBloc-BL 80/250-5,5/4 - 80/270-11/4

4-pole, 50 Hz

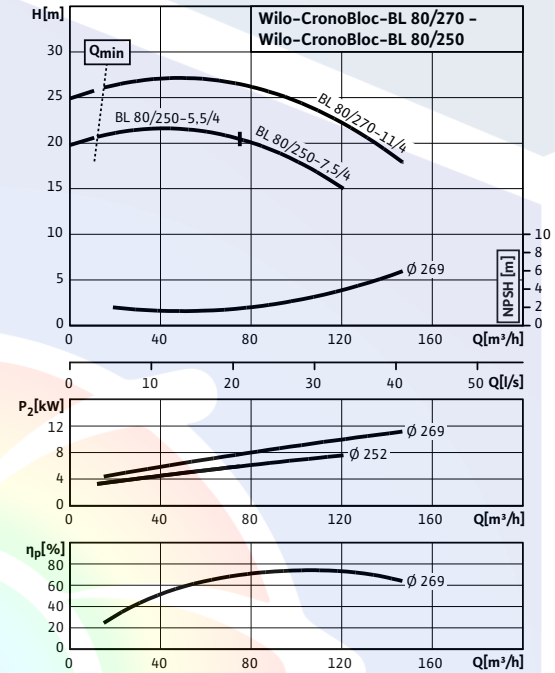

Wilo-CronoBloc-BL 100/145-1,5/4 - 100/170-4/4

4-pole, 50 Hz

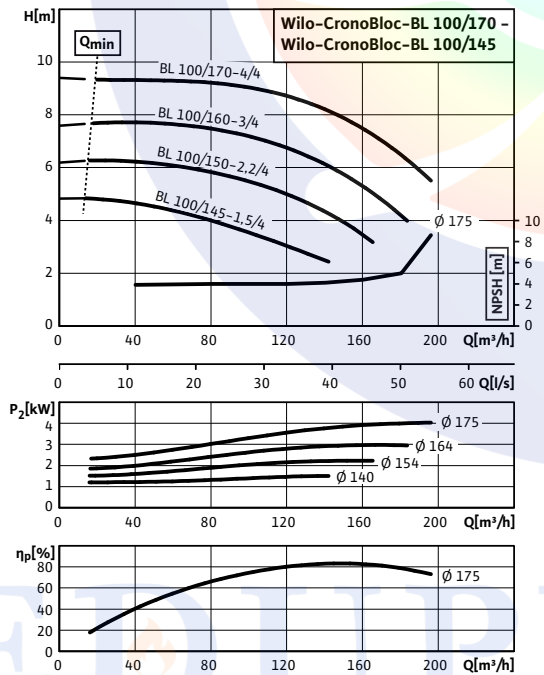

Wilo-CronoBloc-BL 100/180-4/4 - 100/220-7,5/4

4-pole, 50 Hz

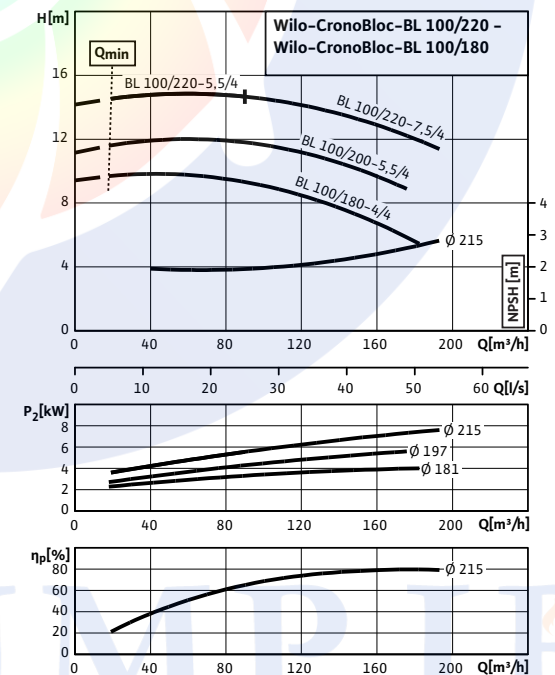

Terminal diagram, motor data Wilo-CronoBloc-BL

Terminal diagram Star switching

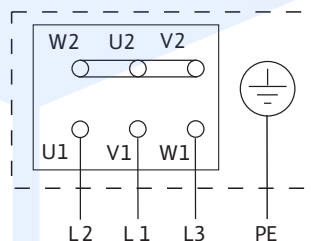

Terminal diagram Delta switching

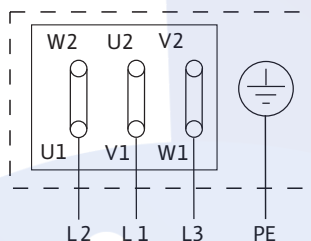

Motor protection switch required onsite. Check the direction of rotation! To change the direction of rotation, swap any two phases.

k

$P_2 \leq 3 \text{ kW}$	3~400 V Y
	3~230 V Δ
$P_2 \geq 4 \text{ kW}$	3~690 V Y
	3~400 V Δ

After removing the bridges, a Y- Δ start is possible.

Motor data (4-pole)

Wilo-CronoBloc-BL...	Nominal current (approx.)	Power factor	Efficiency
	I_N 3~400 V A	$\cos \varphi$	η_M
0.37 kW	0.96	0.73	0.76
0.55 kW	1.25	0.78	0.78
0.75 kW	1.90	0.72	0.80
1.1 kW	2.60	0.77	0.81
1.5 kW	3.40	0.75	0.83
2.2 kW	5.00	0.73	0.84
3 kW	6.50	0.75	0.85
4 kW	8.50	0.77	0.87
5.5 kW	11.00	0.78	0.88
7.5 kW	15.00	0.81	0.89
11 kW	22.20	0.80	0.90
15 kW	28.80	0.83	0.91
18.5 kW	35.00	0.84	0.91
22 kW	41.50	0.84	0.92
30 kW	55.70	0.85	0.92

Observe motor name plate data

Dimensions, weights Wilo-CronoBloc-BL

Dimension drawing Wilo-CronoBloc-BL with B35 motor design from 5.5 kW

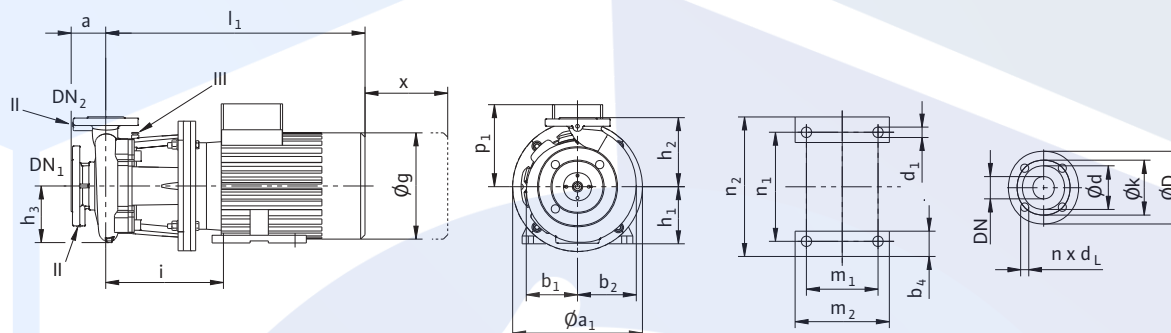

II Pressure measuring connection R¹/₈; III Ventilation R¹/₈

Dimensions, weights (4-pole)

Wilo-CronoBloc-BL...	Nominal diameter		Dimensions																		Weight approx.	
	DN ₁	DN ₂	a	∅ a1	b ₁	b ₂	b ₄	d ₁	∅ g	h ₁	h ₂	h ₃	l	l ₁	m ₁	m ₂	n ₁	n ₂	P ₁	x	m	
	mm																					
50/270-5.5/4	65	50	100	300	174	186	53	12	279	132	225	179	306	622	140	180	216	256	188	110	112	
65/270-5.5/4	80	65	100	300	184	203	53	12	279	132	250	196	304	620	140	180	216	256	188	115	120	
80/220-5.5/4	100	80	125	300	170	197	53	12	279	132	250	178	318	634	140	180	216	256	188	120	119	
80/250-5.5/4	100	80	125	300	192	218	53	12	279	132	280	199	309	625	140	180	216	256	188	120	130	
80/250-7.5/4	100	80	125	300	192	218	53	12	312	132	280	199	309	676	178	218	216	256	250	120	141	
80/270-11/4	100	80	125	350	192	218	60	15	320	160	280	199	369	739	210	256	254	300	250	120	191	
100/200-5.5/4	125	100	125	300	176	211	53	12	279	132	280	196	331	647	140	180	216	256	188	120	125	
100/220-5.5/4	125	100	125	300	176	211	53	12	279	132	280	196	331	647	140	180	216	256	188	120	125	
100/220-7.5/4	125	100	125	300	176	211	53	12	312	132	280	196	331	698	178	218	216	256	250	120	136	
100/250-11/4	125	100	140	350	200	232	60	15	320	160	280	219	383	753	210	256	254	300	250	130	205	
100/270-15/4	125	100	140	350	200	232	60	15	320	160	280	219	383	793	254	300	254	300	250	130	210	
100/300-18.5/4	125	100	140	350	265	297	70	15	370	180	315	248	417	898	241	287	279	339	258	140	265	
100/320-18.5/4	125	100	140	350	265	297	70	15	370	180	315	248	417	898	241	287	279	339	258	140	265	
100/320-22/4	125	100	140	350	265	297	70	15	370	180	315	248	417	898	279	325	279	339	258	140	282	
100/340-30/4	125	100	140	400	265	297	83	19	415	200	315	248	429	955	305	355	318	388	305	140	359	
125/190-5.5/4	150	125	140	300	199	247	53	12	279	132	315	232	343	659	140	180	216	256	188	130	151	
125/200-7.5/4	150	125	140	300	199	247	53	12	312	132	315	232	343	710	178	218	216	256	250	130	162	
125/220-11/4	150	125	140	350	199	247	60	15	320	160	315	232	404	774	210	256	254	300	250	130	212	
125/250-15/4	150	125	140	350	235	279	60	15	320	160	355	256	419	829	254	300	254	300	250	130	250	
125/260-18.5/4	150	125	140	350	235	279	70	15	370	180	355	256	432	913	241	287	279	339	258	130	270	
125/270-22/4	150	125	140	350	235	279	70	15	370	180	355	256	432	913	279	325	279	339	258	130	287	

Dimensions, weights Wilo-CronoBloc-BL

Dimensions, weights (2-pole)

Wilo-CronoBloc-BL...	Nominal diameter		Dimensions																		Weight approx.
	DN ₁	DN ₂	a	∅ a1	b ₁	b ₂	b ₄	d ₁	∅ g	h ₁	h ₂	h ₃	l	l ₁	m ₁	m ₂	n ₁	n ₂	p ₁	x	m
	-		mm																		kg
80/170-30/2	100	80	125	400	160	196	83	18	402	200	225	178	402	928	305	380	318	403	305	135	250
80/200-30/2	100	80	125	400	170	197	83	18	402	200	250	178	403	929	305	380	318	403	305	120	268
80/210-30/2	100	80	125	400	170	197	83	18	402	200	250	178	403	929	305	380	318	403	305	120	268
80/210-37/2	100	80	125	400	170	197	83	18	402	200	250	178	403	929	305	380	318	403	305	120	297
100/145-15/2	125	100	125	350	167	206	60	14	320	160	280	189	387	796	210	260	254	320	250	-	178
100/150-18,5/2	125	100	125	350	167	206	60	14	320	160	280	189	387	797	210	304	254	320	250	-	182
100/160-22/2	125	100	125	350	167	206	70	14	363	180	280	189	400	881	241	300	279	352	291	-	212
100/165-30/2	125	100	125	400	167	206	83	18	402	200	280	189	412	938	305	380	318	403	305	-	258
100/170-37/2	125	100	125	400	167	206	83	18	402	200	280	189	412	938	305	380	318	403	305	-	287

Flange dimensions (suction side)

Wilo-CronoBloc-BL...	Nominal diameter	Pump flange dimensions			
	DN ₁	∅ D ₁	∅ d ₁	∅ k ₁	n x d _{L1}
	-	mm			
32...	50	165	99	125	4 x 19
40...	65	185	118	145	4 x 19
50...	65	185	118	145	4 x 19
65...	80	200	132	160	8 x 19
80...	100	220	156	180	8 x 19
100...	125	250	184	210	8 x 19
125...	150	285	211	240	8 x 23

Pump flange dimensions - according to EN 1092-2 PN 16; n = number of drilled holes

Flange dimensions (discharge side)

Wilo-CronoBloc-BL...	Nominal diameter	Pump flange dimensions			
	DN ₂	∅ D ₂	∅ d ₂	∅ k ₂	n x d _{L2}
	-	mm			
32...	32	140	76	100	4 x 19
40...	40	150	84	110	4 x 19
50...	50	165	99	125	4 x 19
65...	65	185	118	145	4 x 19
80...	80	200	132	160	8 x 19
100...	100	220	156	180	8 x 19
125...	125	250	184	210	8 x 19

Pump flange dimensions - according to EN 1092-2 PN 16; n = number of drilled holes

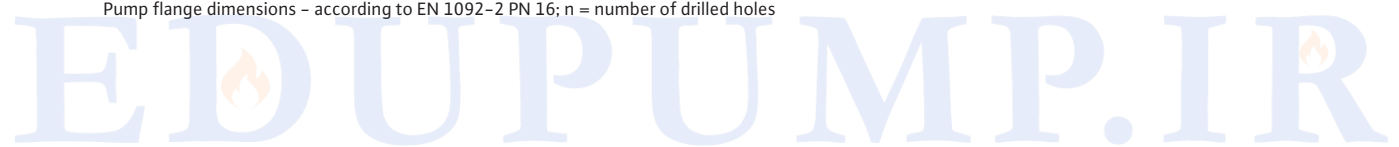



EDUPUMP
WWW.EDUPUMP.IR

اولین و بزرگترین

سایت تخصصی سیستم‌های پمپاژ
با امکان محاسبه آنلاین و انتخاب پمپ

تولید بوستر پمپ آتش نشانی

در کلاس‌های S3 - S2 - S1
مورد تایید سازمان آتش نشانی تهران



اولین و بزرگترین مرجع انتخاب آنلاین سیستم‌های پمپاژ

انتخاب آنلاین انواع بوستر پمپ

انتخاب آنلاین انواع پمپ

ارائه مطالب تخصصی

اولین سایت مرجع

انتخاب آنلاین پمپ

در حوزه‌های:

ایمنی و آتش نشانی
آب و فاضلاب
صنایع غذایی
استخر
صنعت
معدن



تولید بوستر پمپ

آبرسانی دور متغیر

بدون محدودیت برند



آموزش

تهویه و تخلیه دود
سیستم‌های پمپاژ
ایمنی معماری
اطفاء حریق
اعلام حریق

مشاوره - طراحی - اجراء

تاسیسات مکانیکی (موتورخانه - استخر)
تهویه و تخلیه دود
سیستم‌های پمپاژ
ایمنی معماری
اعلام حریق
اطفاء حریق

تهران، سعدی شمالی، خیابان مرادی نور، پلاک ۳۱

تلفن: ۰۲۱-۷۷۶۸۶۹۶۶ فکس: ۰۲۱-۷۷۶۷۸۶۵۹

EDUPUMP.IR

WWW.EDUPUMP.IR