

Heating, air-conditioning, cooling

Glanded monobloc pumps (single pumps)

WILO

Series description Wilo-CronoBloc-BL

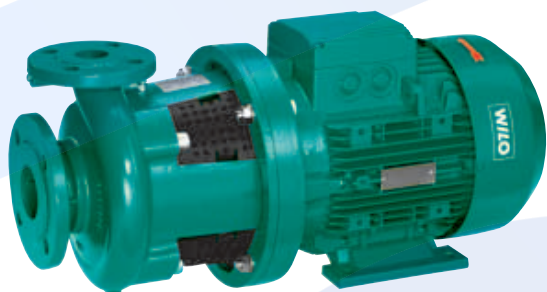

Materials

- Pump housing and lantern: Standard: EN-GJL-250; optional: Spheroidal cast iron EN-GJS-400-18-LT
- Impeller: Standard: EN-GJL-200; Special version: Red brass G-CuSn10
- Shaft: 1.4122
- Mechanical seal: AQEGG; other mechanical seals on request

Description/design

Single-stage low-pressure centrifugal pump in block design, with axial suction port and radially arranged pressure port with

- Mechanical seal
- Flange connection with pressure measuring connection R $\frac{1}{8}$
- Lantern
- Coupling
- IEC standard motor

Design

Glanded pump in block design with flange connection

Application

For pumping cold and hot water (in accordance with VDI 2035) without abrasive substances in heating, cold water and cooling water systems

Scope of delivery

- Pump
- Installation and operating instructions

Type key

Example	BL 40/160-4/2
BL	Monobloc pump
40	Nominal diameter DN of the pipe connection (pressure port)
160	Nominal impeller diameter
4	Nominal motor power P_2 in kW
2	Pole pair number

Technical data

- Permissible temperature range -20°C to $+140^{\circ}\text{C}$
- Mains connection 3~400 V, 50 Hz
- Protection class IP 55
- Nominal diameter DN 32 to DN 125
- Max. operating pressure 16 bar (optionally 25 bar on request)

Special features/product benefits

- High-efficiency motors as standard; from 0.75 kW nominal motor power: motors with IE2 technology
- Reduced life cycle costs due to optimised efficiency
- High corrosion protection due to cathoretic coating of the cast iron components
- Standard condensate drainage holes in the motor housings
- Application benefits in air-conditioning and cooling systems due to direct condensate drainage by means of optimised lantern design
- Bidirectional mechanical seal with forced flushing
- High worldwide obtainability of standard motors (according to Wilo specifications) and mechanical seals
- Meets user requirements due to performance and main dimensions in accordance with EN 733 (DIN for norm pumps)

Heating, air-conditioning, cooling

Glanded monobloc pumps (single pumps)

Series description Wilo-CronoBloc-BL

Wilo-CronoBloc (4-pole)

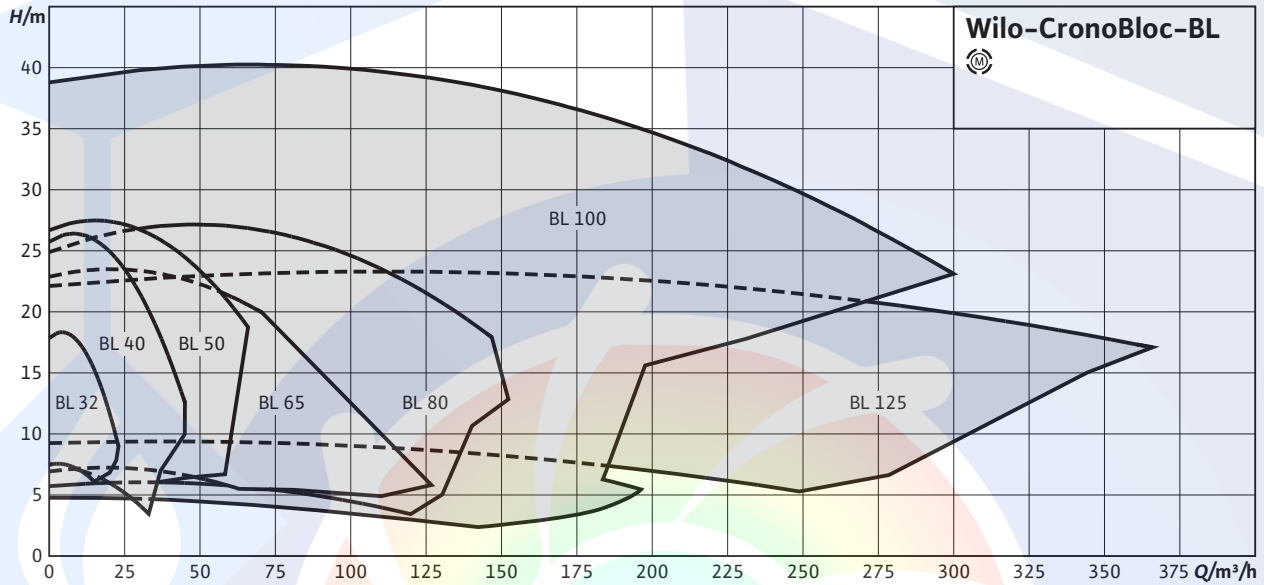

Wilo-CronoBloc (2-pole)

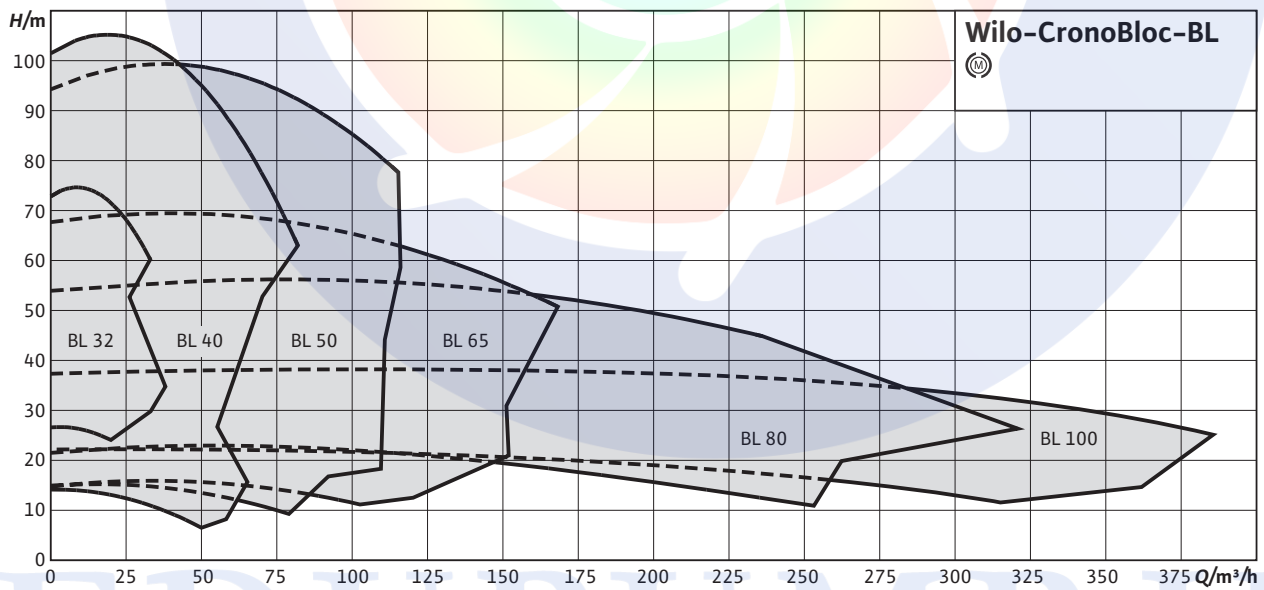

Heating, air-conditioning, cooling

Glanded monobloc pumps (single pumps)

Pump curves Wilo-CronoBloc-BL

Wilo-CronoBloc-BL 40/180-7,5/2 - 40/220-15/2

2-pole, 50 Hz

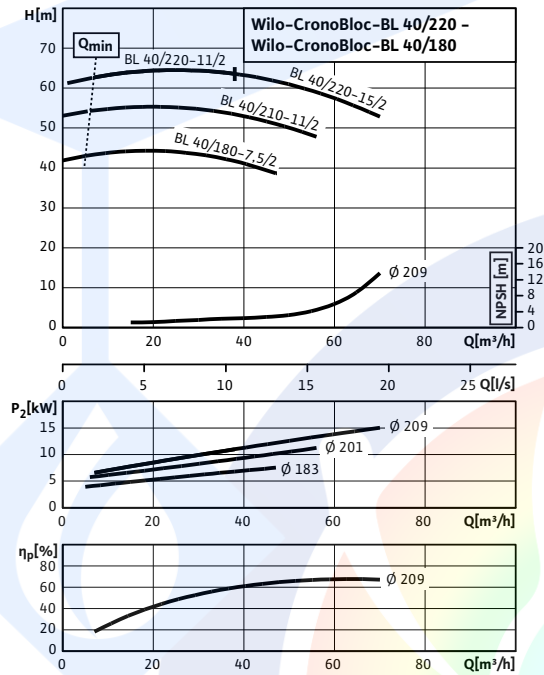

Wilo-CronoBloc-BL 40/250-22/2 - 40/270-30/2

2-pole, 50 Hz

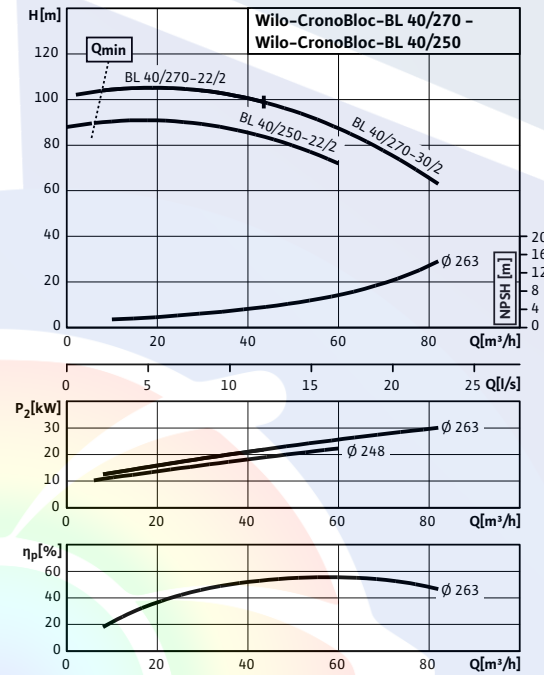

Wilo-CronoBloc-BL 50/110-3/2 - 50/140-7,5/2

2-pole, 50 Hz

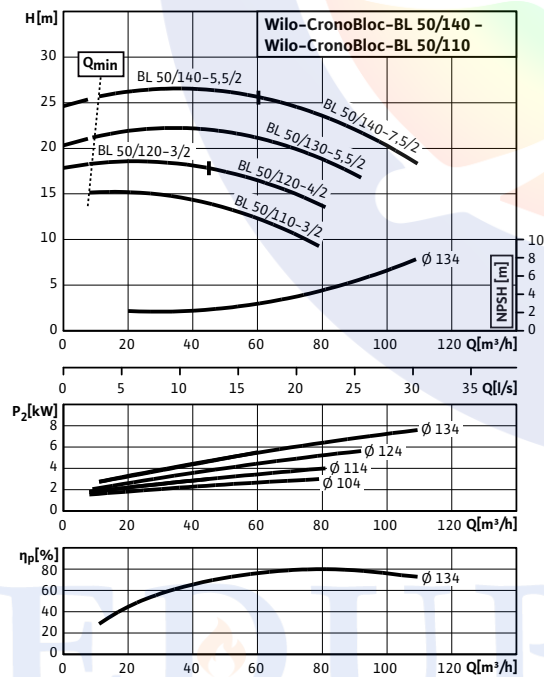

Wilo-CronoBloc-BL 50/150-5,5/2 - 50/170-11/2

2-pole, 50 Hz

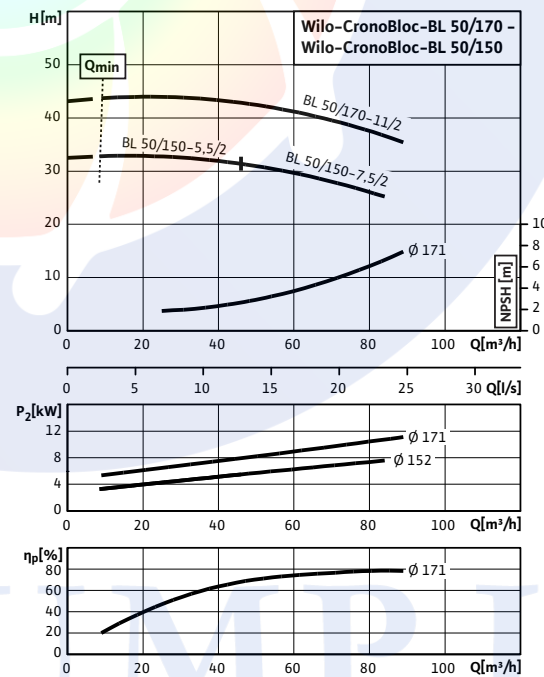

Pump curves Wilo-CronoBloc-BL

Wilo-CronoBloc-BL 50/200-11/2 - 50/220-22/2

2-pole, 50 Hz

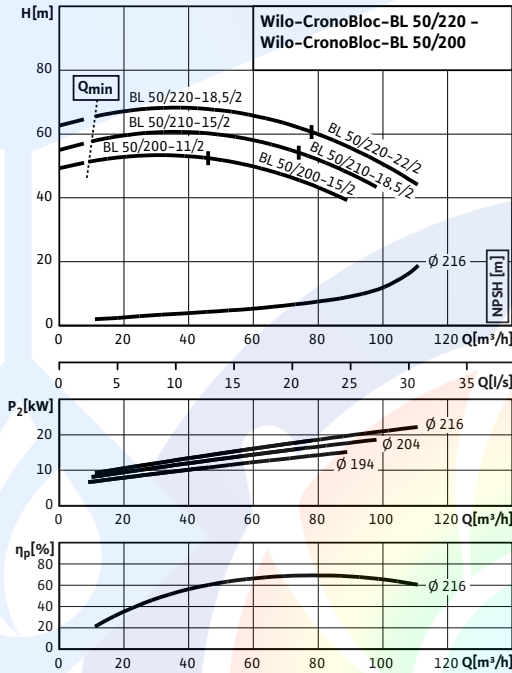

Wilo-CronoBloc-BL 50/240-30/2 - 50/260-37/2

2-pole, 50 Hz

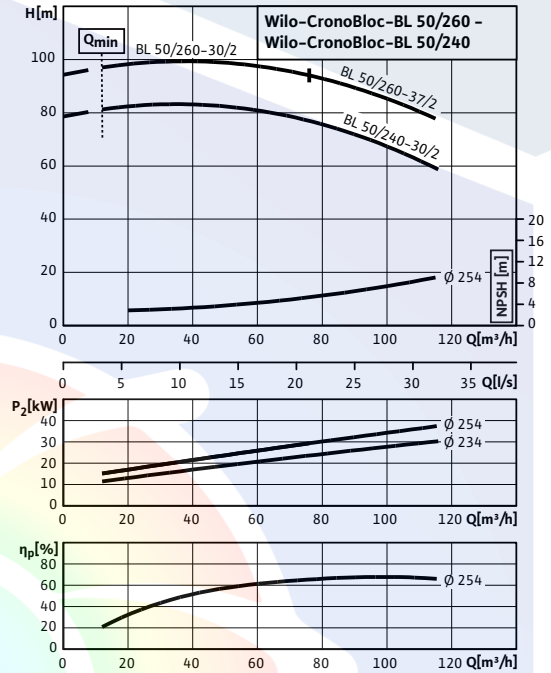

Wilo-CronoBloc-BL 65/120-4/2 - 65/140-7,5/2

2-pole, 50 Hz

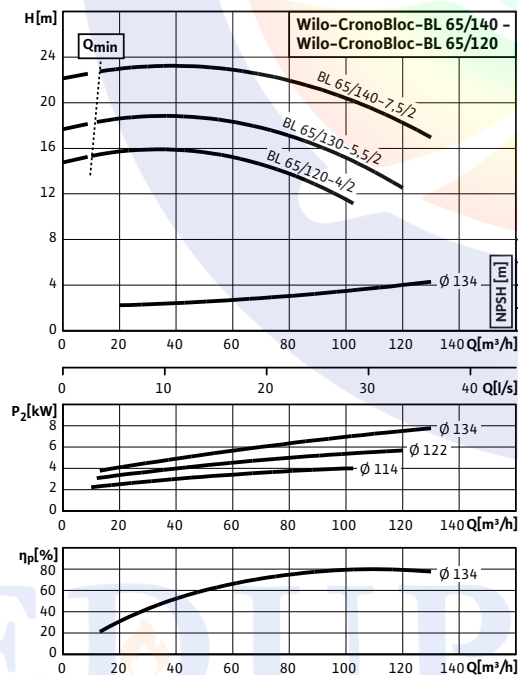

Wilo-CronoBloc-BL 65/160-11/2 - 65/170-15/2

2-pole, 50 Hz

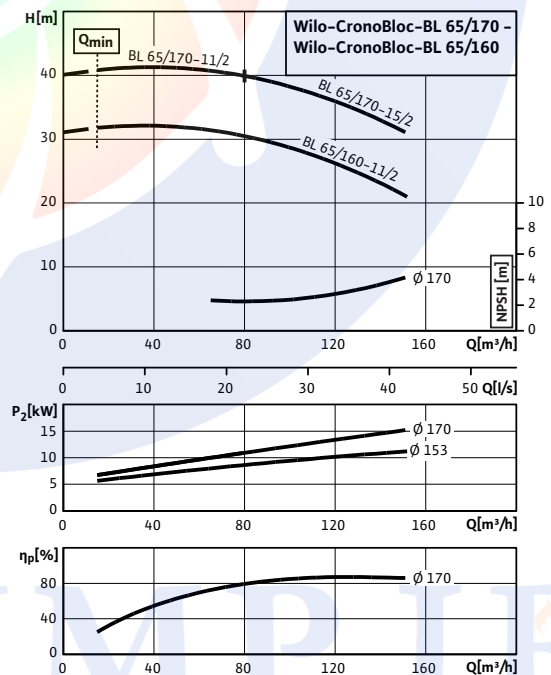

Heating, air-conditioning, cooling

Glanded monobloc pumps (single pumps)

Terminal diagram, motor data Wilo-CronoBloc-BL

Motor data (2-pole)

Wilo-CronoBloc-BL...	Nominal current (approx.)	Power factor	Efficiency
	I_N 3~400 V	$\cos \varphi$	η_M
	A		—
1.5 kW	3.30	0.77	0.81
2.2 kW	4.40	0.87	0.83
3 kW	5.80	0.88	0.85
4 kW	7.70	0.87	0.86
5.5 kW	10.20	0.87	0.87
7.5 kW	13.70	0.89	0.88
11 kW	22.00	0.81	0.89
15 kW	28.50	0.84	0.90
18.5 kW	34.20	0.86	0.91
22 kW	40.70	0.85	0.91
30 kW	53.00	0.85	0.92
37 kW	65.00	0.88	0.93

Observe motor name plate data

EDUPUMP.IR

Heating, air-conditioning, cooling

Glanded monobloc pumps (single pumps)

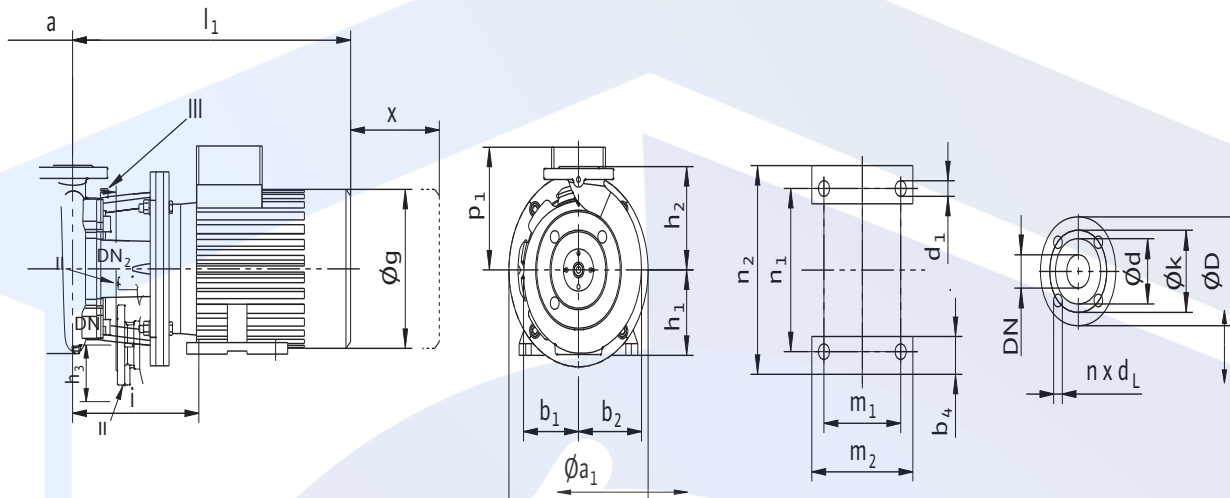

II Pressure measuring connection $R^{1/8}$; III Ventilation $R^{1/8}$

Dimensions, weights (2-pole)

Wilo-CronoBloc-BL...	Nominal diameter		Dimensions														Weight approx. m	
	DN ₁	DN ₂	a	b ₁	b ₂	b ₃	Øg	h ₁	h ₂	h ₃	l	l ₁	n ₃	p ₁	q	x		m
	mm																	kg
32/140-2.2/2	50	32	80	113	129	144	193	160	160	122	110	476	130	-	144	95	54	
32/150-3/2	50	32	80	113	129	150	217	160	160	122	110	531	130	-	150	95	61	
32/160-4/2	50	32	80	113	129	156	232	160	160	122	110	555	130	-	156	95	72	
40/110-1.5/2	65	40	80	101	119	144	193	160	140	111	114	447	130	-	144	100	47	
40/120-2.2/2	65	40	80	101	119	144	193	160	140	111	114	474	130	-	144	100	50	
40/130-3/2	65	40	80	101	119	150	217	160	140	111	114	530	130	-	150	100	55	
40/140-3/2	65	40	80	101	119	150	217	160	140	111	114	530	130	-	150	100	57	
40/140-4/2	65	40	80	101	119	156	232	160	140	111	114	554	130	-	156	100	69	
50/110-3/2	65	50	100	111	133	150	217	160	160	124	121	537	130	-	150	110	60	
50/120-3/2	65	50	100	111	133	150	217	160	160	124	121	537	130	-	150	110	60	
50/120-4/2	65	50	100	111	133	156	232	160	160	124	121	561	130	-	156	110	72	
65/120-4/2	80	65	100	123	151	156	232	160	180	155	127	566	130	-	156	120	77	

EDUPUMP.IR

Dimensions, weights Wilo-CronoBloc-BL

Dimensions, weights (2-pole)

Wilo-CronoBloc-BL...	Nominal diameter		Dimensions																		Weight approx.
	DN ₁	DN ₂	a	∅ a1	b ₁	b ₂	b ₄	d ₁	∅ g	h ₁	h ₂	h ₃	l	l ₁	m ₁	m ₂	n ₁	n ₂	p ₁	x	m
	-		mm																		kg
80/170-30/2	100	80	125	400	160	196	83	18	402	200	225	178	402	928	305	380	318	403	305	135	250
80/200-30/2	100	80	125	400	170	197	83	18	402	200	250	178	403	929	305	380	318	403	305	120	268
80/210-30/2	100	80	125	400	170	197	83	18	402	200	250	178	403	929	305	380	318	403	305	120	268
80/210-37/2	100	80	125	400	170	197	83	18	402	200	250	178	403	929	305	380	318	403	305	120	297
100/145-15/2	125	100	125	350	167	206	60	14	320	160	280	189	387	796	210	260	254	320	250	-	178
100/150-18,5/2	125	100	125	350	167	206	60	14	320	160	280	189	387	797	210	304	254	320	250	-	182
100/160-22/2	125	100	125	350	167	206	70	14	363	180	280	189	400	881	241	300	279	352	291	-	212
100/165-30/2	125	100	125	400	167	206	83	18	402	200	280	189	412	938	305	380	318	403	305	-	258
100/170-37/2	125	100	125	400	167	206	83	18	402	200	280	189	412	938	305	380	318	403	305	-	287

Flange dimensions (suction side)

Wilo-CronoBloc-BL...	Nominal diameter	Pump flange dimensions			
	DN ₁	∅ D ₁	∅ d ₁	∅ k ₁	n x d _{L1}
	-	mm			
32...	50	165	99	125	4 x 19
40...	65	185	118	145	4 x 19
50...	65	185	118	145	4 x 19
65...	80	200	132	160	8 x 19
80...	100	220	156	180	8 x 19
100...	125	250	184	210	8 x 19
125...	150	285	211	240	8 x 23

Pump flange dimensions - according to EN 1092-2 PN 16; n = number of drilled holes

Flange dimensions (discharge side)

Wilo-CronoBloc-BL...	Nominal diameter	Pump flange dimensions			
	DN ₂	∅ D ₂	∅ d ₂	∅ k ₂	n x d _{L2}
	-	mm			
32...	32	140	76	100	4 x 19
40...	40	150	84	110	4 x 19
50...	50	165	99	125	4 x 19
65...	65	185	118	145	4 x 19
80...	80	200	132	160	8 x 19
100...	100	220	156	180	8 x 19
125...	125	250	184	210	8 x 19

Pump flange dimensions - according to EN 1092-2 PN 16; n = number of drilled holes



EDUPUMP
WWW.EDUPUMP.IR

اولین و بزرگترین

سایت تخصصی سیستم‌های پمپاژ
با امکان محاسبه آنلاین و انتخاب پمپ

تولید بوستر پمپ آتش نشانی

در کلاس‌های S3 - S2 - S1
مورد تایید سازمان آتش نشانی تهران



اولین و بزرگترین مرجع انتخاب آنلاین سیستم‌های پمپاژ

انتخاب آنلاین انواع بوستر پمپ

انتخاب آنلاین انواع پمپ

ارائه مطالب تخصصی

اولین سایت مرجع

انتخاب آنلاین پمپ

در حوزه‌های:

ایمنی و آتش نشانی
آب و فاضلاب
صنایع غذایی
استخر
صنعت
معدن



تولید بوستر پمپ

آبرسانی دور متغیر

بدون محدودیت برند



آموزش

تهویه و تخلیه دود
سیستم‌های پمپاژ
ایمنی معماری
اطفاء حریق
اعلام حریق

مشاوره - طراحی - اجراء

تاسیسات مکانیکی (موتورخانه - استخر)
تهویه و تخلیه دود
سیستم‌های پمپاژ
ایمنی معماری
اعلام حریق
اطفاء حریق

تهران، سعدی شمالی، خیابان مرادی نور، پلاک ۳۱

تلفن: ۰۲۱-۷۷۶۸۶۹۶۶ فکس: ۰۲۱-۷۷۶۷۸۶۵۹

EDUPUMP.IR

WWW.EDUPUMP.IR